



## MuteClip® Installation Guides

---

### Wall

- 02 - To Stud Wall
- 04 - Direct to Wall
- 06 - Windows, Doors, Openings and Pitched Ceilings

### Ceiling

- 08 - Direct to Concrete Ceiling
- 10 - To Battened Concrete Ceiling
- 12 - To Wooden Joist Ceiling
- 15 - MuteClip XP
- 17 - MuteClip LP

## To Stud Wall



*Suitability of fixings to be confirmed by installer.*

## Instructions

- Install a Stud wall 5mm off the original wall.
  - + 600mm centres for the stud vertical struts with sufficient noggins to strengthen the structure.
- Insert Acoustic Mineral Wool between the stud frame.
  - + Acoustic Mineral Wool can be friction-held between the joists/battens, if required use thin wiring to keep it suspended.
- Measure up and mark out the appropriate locations for the MuteClips (*See configurations or contact iKoustic for appropriate dimensions*).
  - + The perimeter MuteClips must be no further than 100mm from the adjacent surfaces.
- MuteClips to be spaced a maximum of 600mm apart vertically.

- + MuteClip centres to vary between 600 and 1200mm centres creating a Diamond configuration.
- Attach MuteClip Channels into MuteClips, channels should run horizontally.
  - + MuteClip Channels must overlap by 200mm, fix 4 self-tapping screws into the shoulders of the MuteClip Channels to give a secure join.
- MuteClip Channels should not overlap on a MuteClip.
- Fix your first layer of Acoustic Plasterboard to the MuteClip Channels.
  - + Acoustic Plasterboard must not be in direct contact with any adjacent surfaces. There should be a 2-5mm gap around the perimeter of the surface.
- Seal the perimeter and any other gaps with Acoustic Sealant.
- Adhere Tecsound to the Acoustic Plasterboard using Tecsound's self-adhesive backing.
  - + It may be easier to cut Tecsound into manageable sized pieces for ease of installation.
- Fix your second layer of Acoustic Plasterboard, stagger the joist from the first layer, making sure that the screws go into the MuteClip Channels.
  - + Again, leave a 2-5mm gap around the perimeter of the room.
- Seal the perimeter and any other gaps with Acoustic Sealant.
- Scrim tape all joins and finish with a skim plaster.

## Configurations

### Standard Diamond

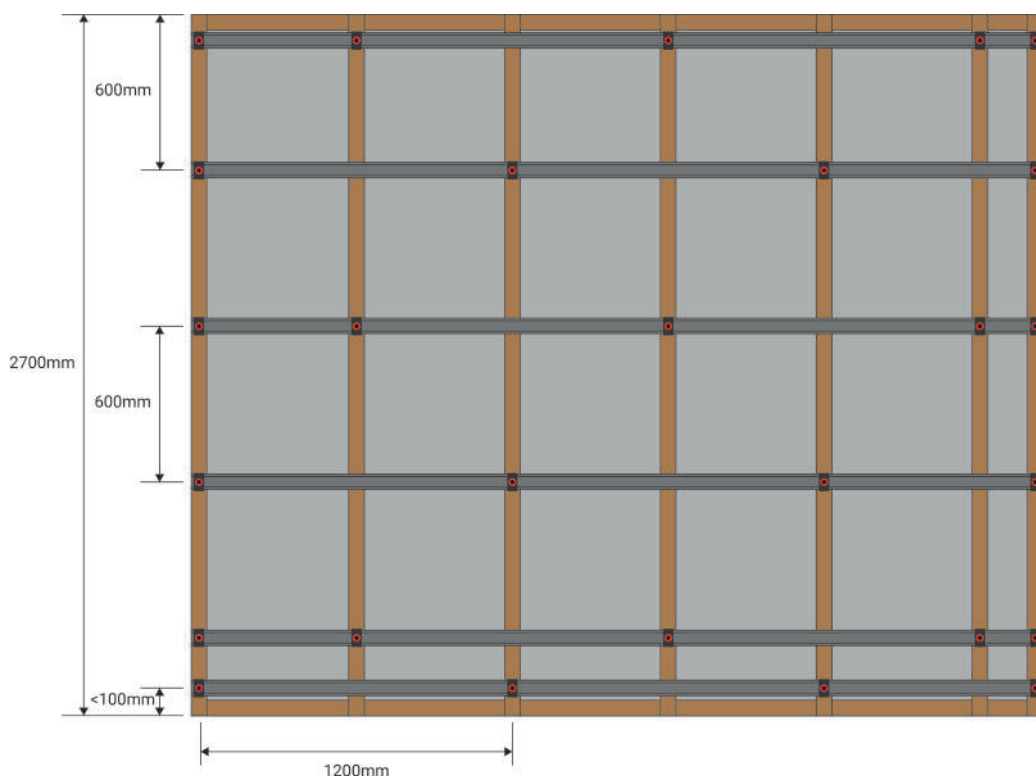

*Please contact iKoustic to confirm correct configurations appropriate for your system.*

**If you need any assistance, please call us on 01937 588 226.**

# MuteClip® Installation Guide Wall

## Direct to Wall

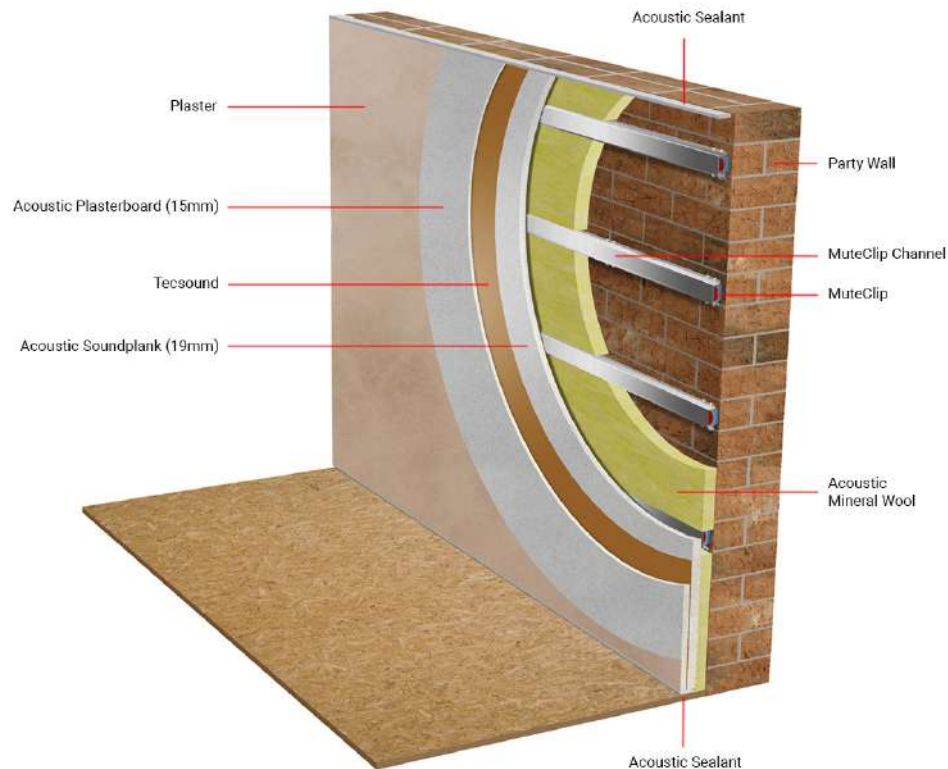

### Fixings

MuteClip Direct to Wall	- Hammer Fix Plug & Screw
1st Plasterboard to Channel	- 32mm Fine Thread Dry Wall Screw
2nd Plasterboard to Channel	- 50mm Fine Thread Dry Wall Screw
MuteClip Channel Overlap	- 20mm Steel Self-Tapping Screw

*Suitability of fixings to be confirmed by installer.*

### Instructions

- Measure up the wall being treated and mark out the locations for the MuteClips (*See configurations or contact iKoustic for appropriate dimensions*).
  - + The perimeter MuteClips should be no further than 100mm from the adjacent surfaces.
- Hammer fix screw directly into brickwork to secure the MuteClip.
  - + Drill hole in the wall, plug this hole and fix the screw through the Clip into the hole.
- MuteClips to be spaced a maximum of 600mm apart vertically
  - + MuteClip centres to vary between 600 and 1200mm centres creating a Diamond configuration (*See configurations or contact iKoustic for appropriate dimensions*).
- Attach MuteClip Channels into MuteClips, channels must run horizontally.

- + MuteClip Channels must overlap by 200mm, fix 4 self-tapping screws into the shoulders of the MuteClip Channels to give a secure join.
- MuteClip Channels should not overlap on a MuteClip.
- Insert Acoustic Mineral Wool between/behind the MuteClip Channels.
- Fix your first layer of Acoustic Plasterboard to the MuteClip Channels.
- + Acoustic Plasterboard must not be in direct contact with any adjacent surfaces. There must be a 2-5mm gap around the perimeter of the room.
- Seal the perimeter and any other gaps with Acoustic Sealant.
- Adhere Tecsound to the Acoustic Plasterboard using Tecsound's self-adhesive backing.
- It may be easier to cut Tecsound into manageable sized pieces for ease of installation.
- Fix your second layer of Acoustic Plasterboard and stagger the joins from the first layer, making sure that the screws go into the MuteClip Channels.
- + Again, leave a 2-5mm gap around the perimeter of the room.
- Seal the perimeter and any other gaps with Acoustic Sealant.
- Scrim tape all joins and finish with a skim plaster.

## Configurations

### Standard Diamond

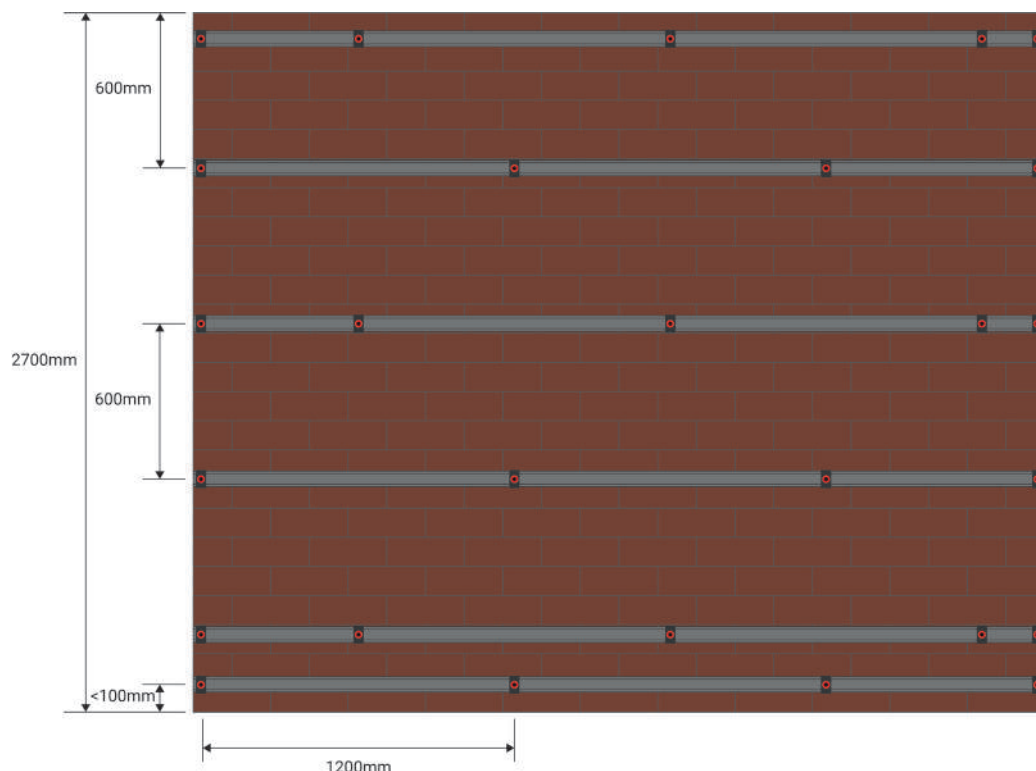

*Please contact iKoustic to confirm correct configurations appropriate for your system.*

**If you need any assistance, please call us on 01937 588 226.**

# MuteClip® Installation Guide Wall

## Windows, Doors, Openings and Pitched Ceilings

### Windows and Doors

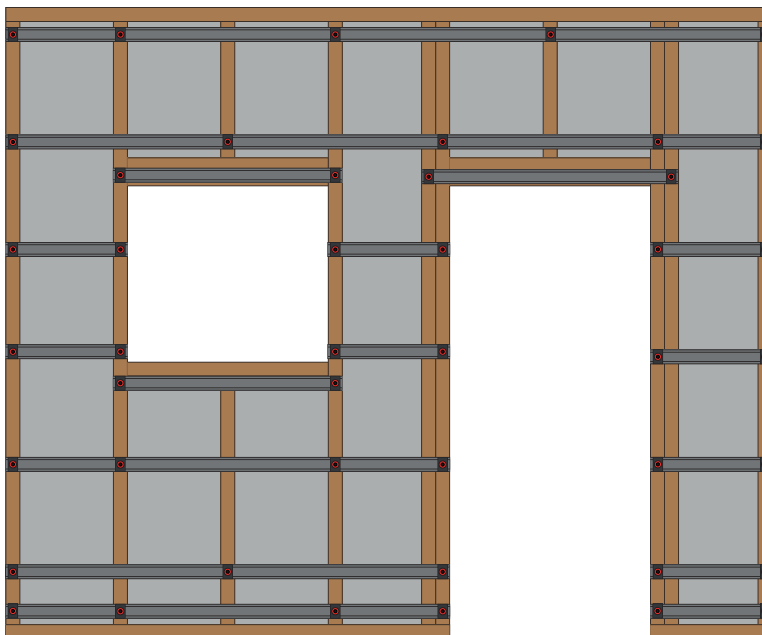

When installing a MuteClip system around a Door or Window, a piece of channel should be installed above each door and window to ensure the plasterboard is supported along the edge.

### Perimeter Details

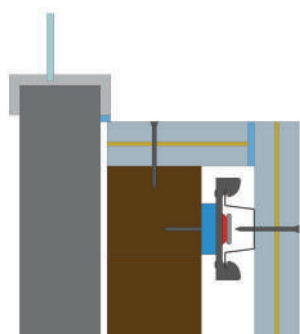

MuteClip® Stud System  
Window - Side View

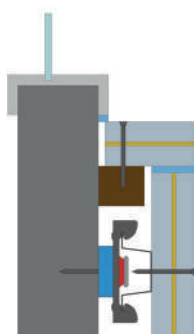

MuteClip® Direct to Wall System  
Window - Side View

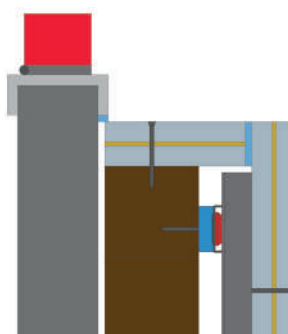

MuteClip® Stud System  
Door - Top View

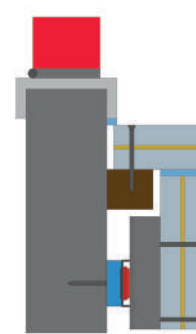

MuteClip® Direct to Wall System  
Door - Top View

*Please contact iKoustic to confirm correct configurations appropriate for your system.*

**If you need any assistance, please call us on 01937 588 226.**

# MuteClip® Installation Guide Wall

Windows, Doors, Openings and Pitched Ceilings

## Vents and Openings

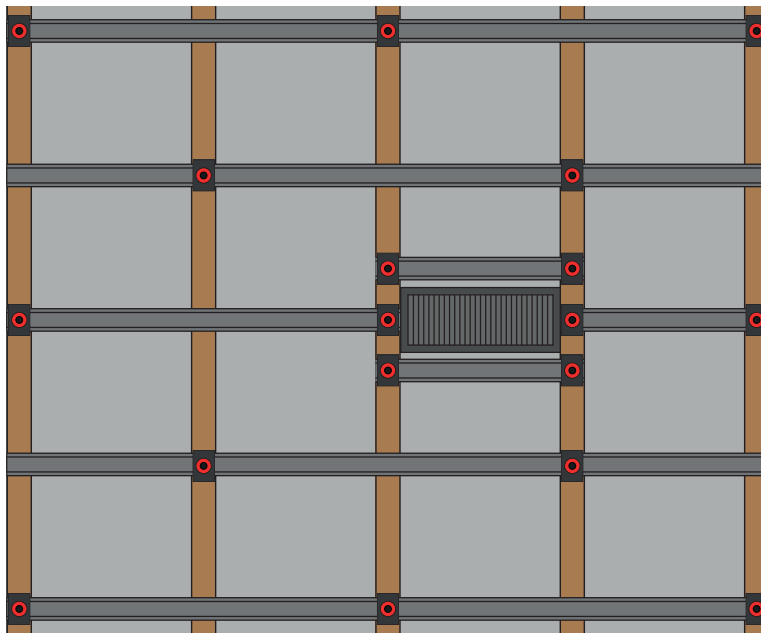

MuteClip Channel must not be installed over any opening or vent in your wall or ceiling system. To overcome this, install a MuteClip and MuteClip Channel section above the opening or vent. This will help support the weight of the system.

## Pitched Ceilings

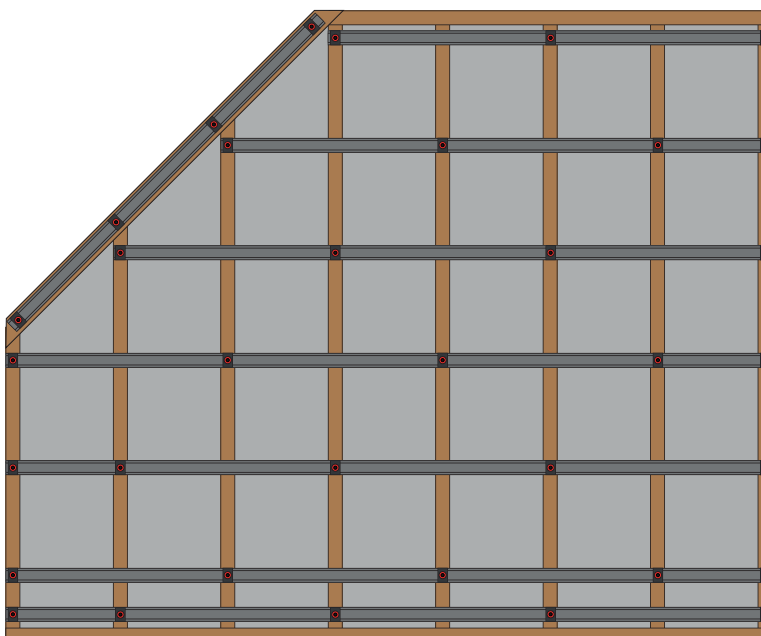

When installing a MuteClip system on a pitched roof use one section of channel supported by clips along the slanted side to ensure the plasterboard is supported along the edge.

*Please contact iKoustic to confirm correct configurations appropriate for your system.*

**If you need any assistance, please call us on 01937 588 226.**



# MuteClip® Installation Guide Ceiling

## Direct to Concrete Ceiling

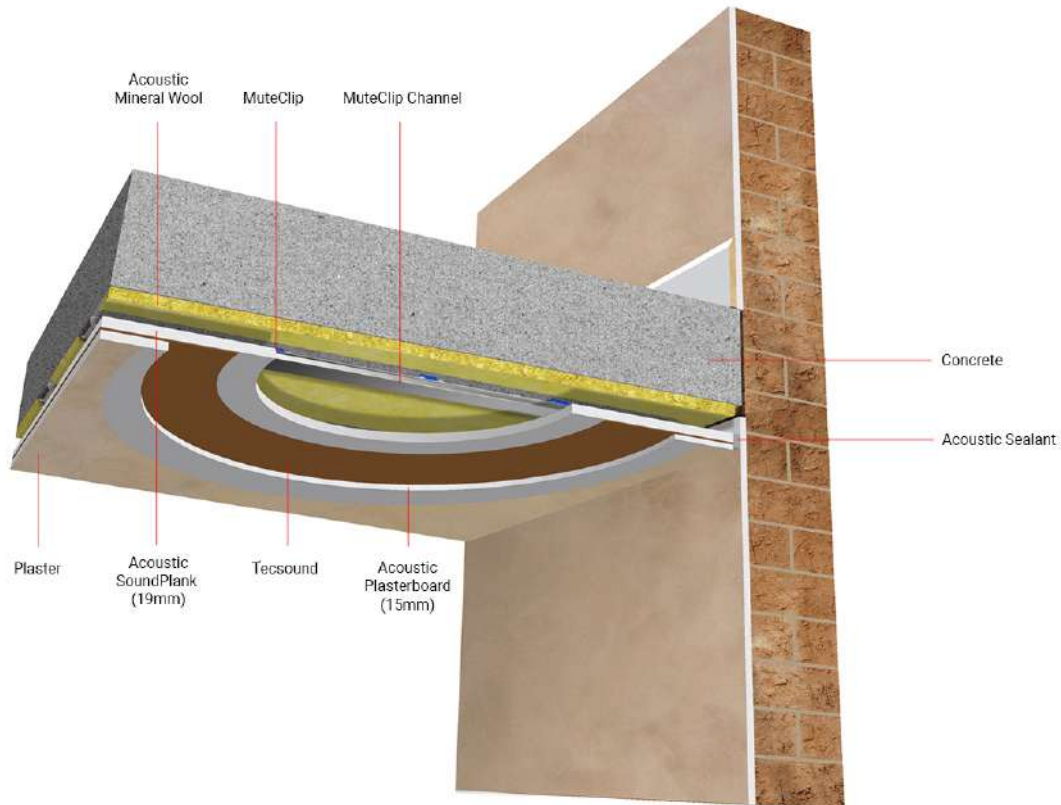

### Fixings

MuteClip to Concrete Substrate	- Anchor Bolt
1st Plasterboard to Channel	- 32mm Fine Thread Dry Wall Screw
2nd Plasterboard to Channel	- 50mm Fine Thread Dry Wall Screw
MuteClip Channel Overlap	- 20mm Steel Self-Tapping Screw

*Suitability of fixings to be confirmed by installer.*

### Instructions

- Measure up the ceiling you will be treating and mark out the locations for the clips (*See configurations or contact iKoustic for appropriate dimensions*).
  - + The perimeter MuteClips should be no further than 100mm from the adjacent walls.
- Securely anchor bolt the MuteClips directly into the concrete ceiling at the appropriate centres (*See configurations or contact iKoustic for appropriate dimensions*).
- Attach MuteClip Channels into MuteClips.
  - + MuteClip Channels should overlap by 200mm, fix 4 self-tapping screws into the shoulders of the channels to give a secure join.
- MuteClip Channels should not overlap on a MuteClip.
- Insert Acoustic Mineral Wool behind the MuteClip Channels.



- Fix your first layer of Acoustic Plasterboard to the MuteClip Channels.
  - + Acoustic Plasterboard must not be in direct contact with any adjacent surfaces. There must be a 2-5mm gap around the perimeter of the room.
- Seal the perimeter and any other gaps with Acoustic Sealant.
- Adhere Tecsound to the Acoustic Plasterboard using Tecsound's self-adhesive backing.
  - + It may be easier to cut Tecsound into manageable sized pieces for ease of installation.
- Fix your second layer of Acoustic Plasterboard and stagger the joins from the first layer, making sure that the screws go into the MuteClip Channels.
  - + Again, leave a 2-5mm gap around the perimeter of the room.
- Seal the perimeter and any other gaps with Acoustic Sealant.
- Scrim tape all joins and finish with a skim plaster.

## Configurations

### Standard Diamond

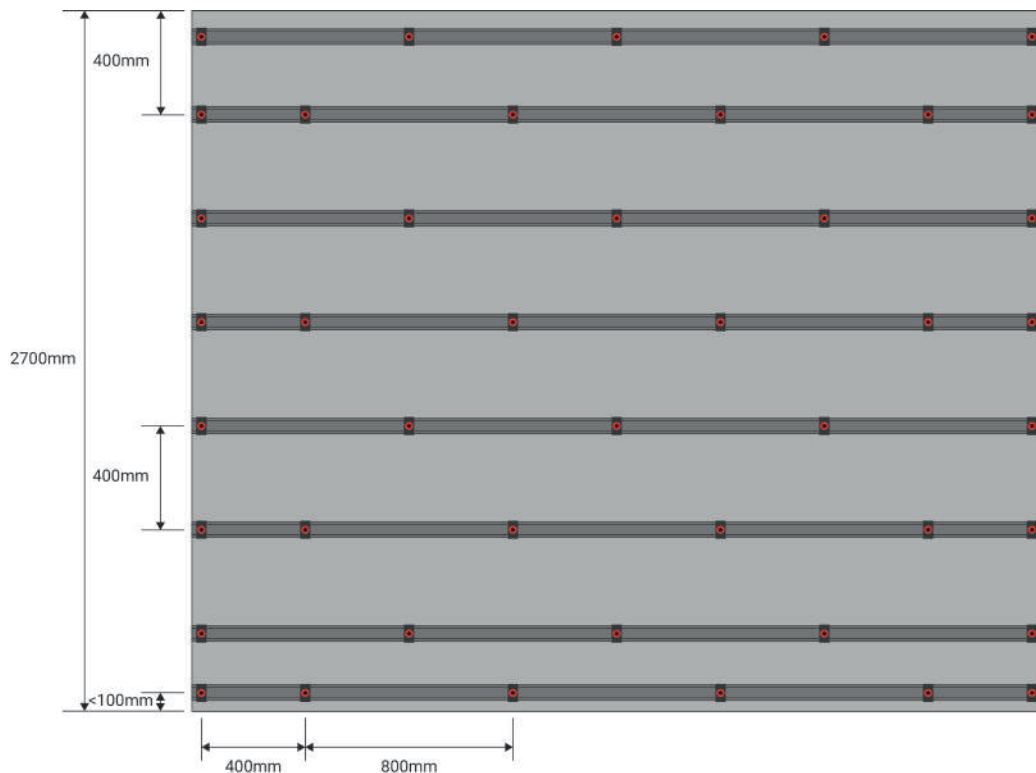

*Please contact iKoustic to confirm correct configurations appropriate for your system.*

**If you need any assistance, please call us on 01937 588 226.**

# MuteClip® Installation Guide Ceiling

## Direct to Battened Concrete Ceiling

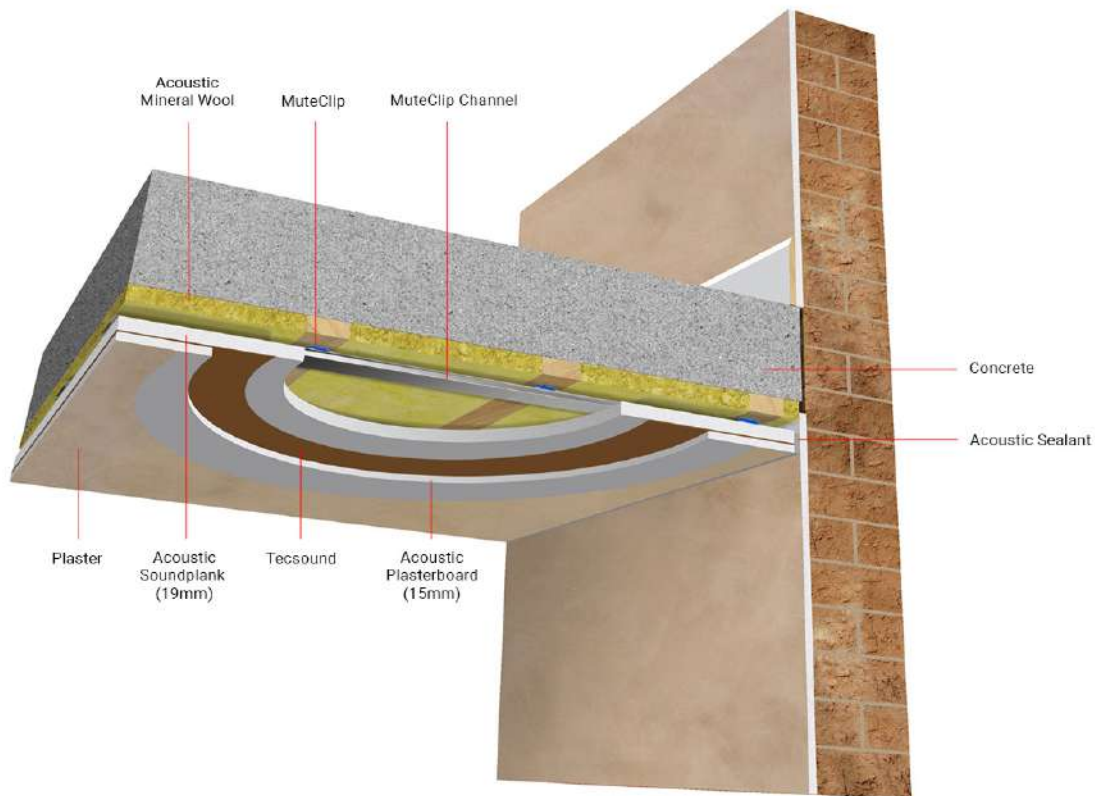

### Fixings

Battens to Concrete	- Anchor Bolt
MuteClip to Battens	- 5mm x 60mm Coarse Thread Wood Screw
1st Plasterboard to Channel	- 32mm Fine Thread Dry Wall Screw
2nd Plasterboard to Channel	- 50mm Fine Thread Dry Wall Screw
MuteClip Channel Overlap	- 20mm Steel Self-Tapping Screw

*Suitability of fixings to be confirmed by installer.*

### Instructions

- Measure up the ceiling you will be treating and mark out the locations for the battens (*See configurations or contact iKoustic for appropriate dimensions*).
- Apply MuteStrip or Isolation Strip to the side of the timber that will be in direct contact with the ceiling.
- Ensuring the timber frame is at appropriate centres, securely anchor bolt the timber frame to the ceiling.
- Mark out the locations for the MuteClips (*See configurations or contact iKoustic for appropriate dimensions*).
  - + The perimeter MuteClips must be no further than 100mm from the adjacent walls.
- Screw MuteClips into the appropriate joists.
- Attach MuteClip Channels into MuteClips, channels must run perpendicular to the joists/battens.
  - + MuteClip Channels must overlap by 200mm, fix 4 self-tapping screws into the shoulders of the MuteClip Channels to give a secure join.

- + MuteClip Channels must not overlap on a MuteClip.
- Insert acoustic Mineral Wool between the joists/battens.
  - + Acoustic Mineral Wool can be friction-held between the joists/battens, if required use thin wiring to keep it suspended.
- Fix your first layer of Acoustic Plasterboard to the MuteClip Channels.
  - + Acoustic Plasterboard must not be in direct contact with any adjacent surfaces. There must be a 2-5mm gap around the perimeter of the room.
- Seal the perimeter and any other gaps with Acoustic Sealant.
- Adhere Tecsound to the Acoustic Plasterboard using Tecsound's self-adhesive backing.
  - + It may be easier to cut Tecsound into manageable sized pieces for ease of installation.
- Fix your second layer of Acoustic Plasterboard and stagger the joins from the first layer, making sure that the screws go into the MuteClip Channels.
  - + Again, leave a 2-5mm gap around the perimeter of the room.
- Seal the perimeter and any other gaps with Acoustic Sealant.
- Scrim tape all joins and finish with a skim plaster.

## Configurations

### Standard Diamond

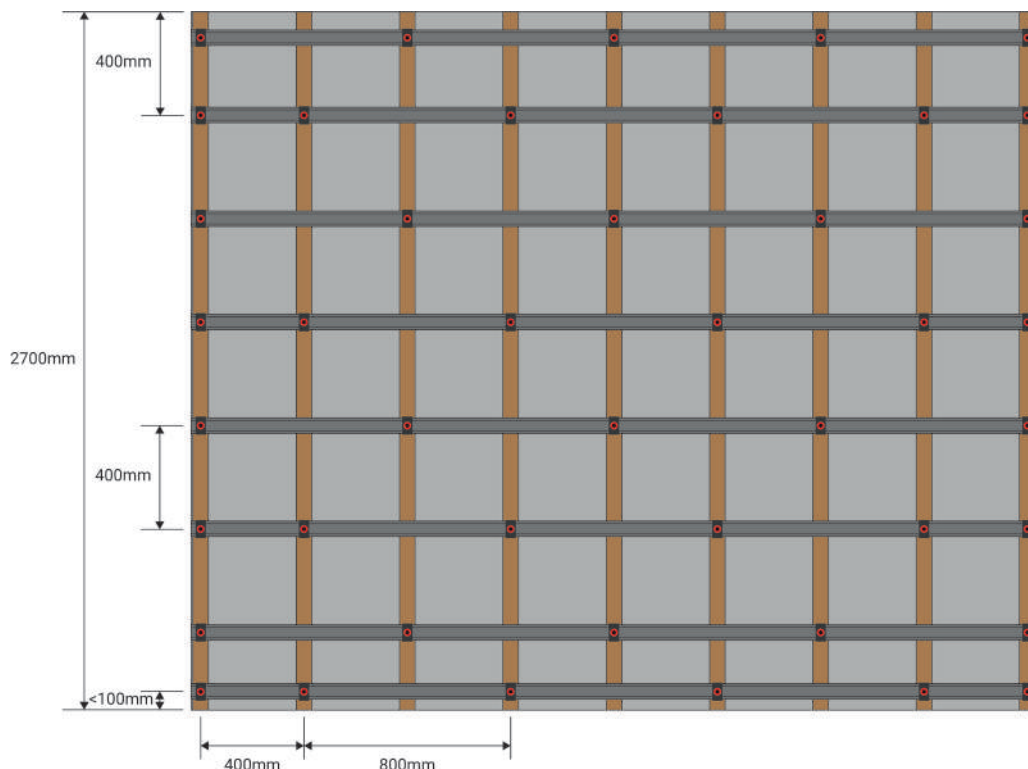

*Please contact iKoustic to confirm correct configurations appropriate for your system.*

**If you need any assistance, please call us on 01937 588 226.**

# MuteClip® Installation Guide Ceiling

## To Wooden Joist Ceiling

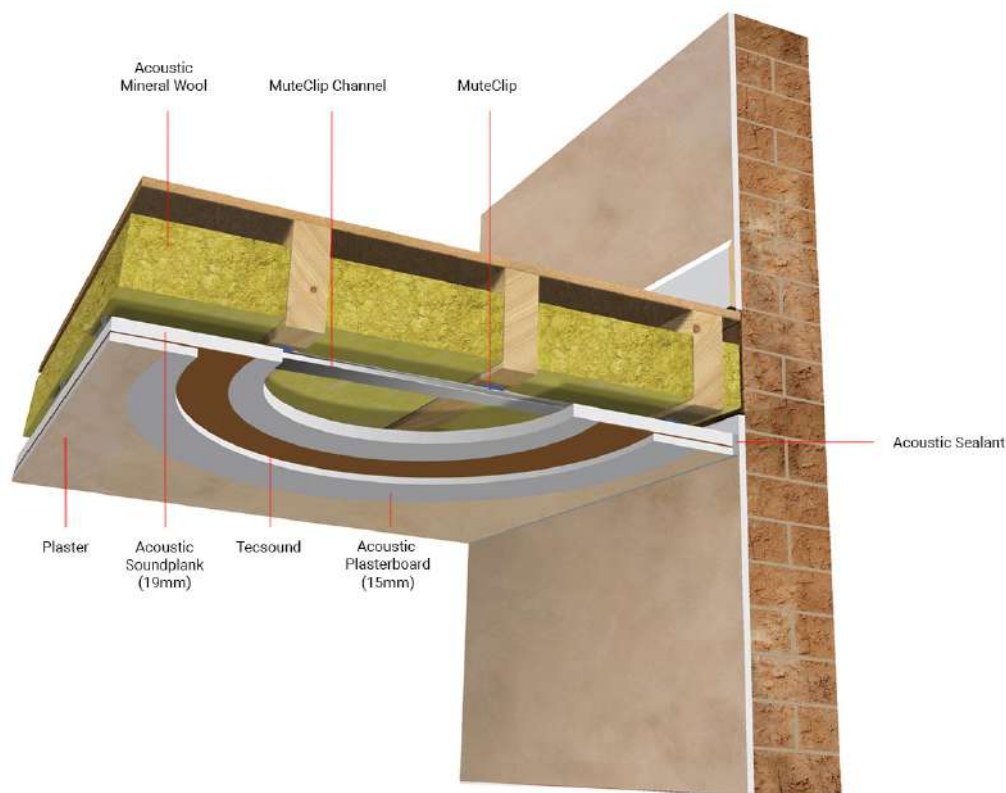

### Fixings

MuteClip to Wooden Joist	- 5mm x 60mm Wood Screw
1st Plasterboard to Channel	- 32mm Fine Thread Dry Wall Screw
2nd Plasterboard to Channel	- 50mm Fine Thread Dry Wall Screw
MuteClip Channel Overlap	- 20mm Steel Self-Tapping Screw

*Suitability of fixings to be confirmed by installer.*

### Instructions

- Insert Acoustic Mineral Wool between the joists.
  - + Acoustic Mineral Wool can be friction-held between the joists/battens, if required use thin wiring to keep it suspended.
- Mark out the locations for the MuteClips (*See configurations or contact iKoustic for appropriate dimensions*).
  - + The perimeter MuteClips must be no further than 100mm from the adjacent walls.
- Screw Clips into all the appropriate joists.
- Attach MuteClip Channels into MuteClips, channels must run perpendicular to the joists.
  - + MuteClip Channels must overlap by 200mm, fix 4 self-tapping screws into the shoulders of the MuteClip Channels to give a secure join.

- + MuteClip Channels must not overlap on a MuteClip.
- Fix your first layer of Acoustic Plasterboard to the MuteClip Channels.
  - + Acoustic Plasterboard must not be in direct contact with any adjacent surfaces. There must be a 2-5mm gap around the perimeter of the room.
- Seal the perimeter and any other gaps with Acoustic Sealant.
- Adhere Tecsound to the Acoustic Plasterboard using Tecsound's self-adhesive backing.
  - + It may be easier to cut Tecsound into manageable sized pieces for ease of installation.
- Fix your second layer of Acoustic Plasterboard and stagger the joins from the first layer, making sure that the screws go into the MuteClip Channels.
  - + Again, leave a 2-5mm gap around the perimeter of the room.
- Seal the perimeter and any other gaps with Acoustic Sealant.
- Scrim tape all joins and finish with a skim plaster.

## Configurations

### Standard Diamond

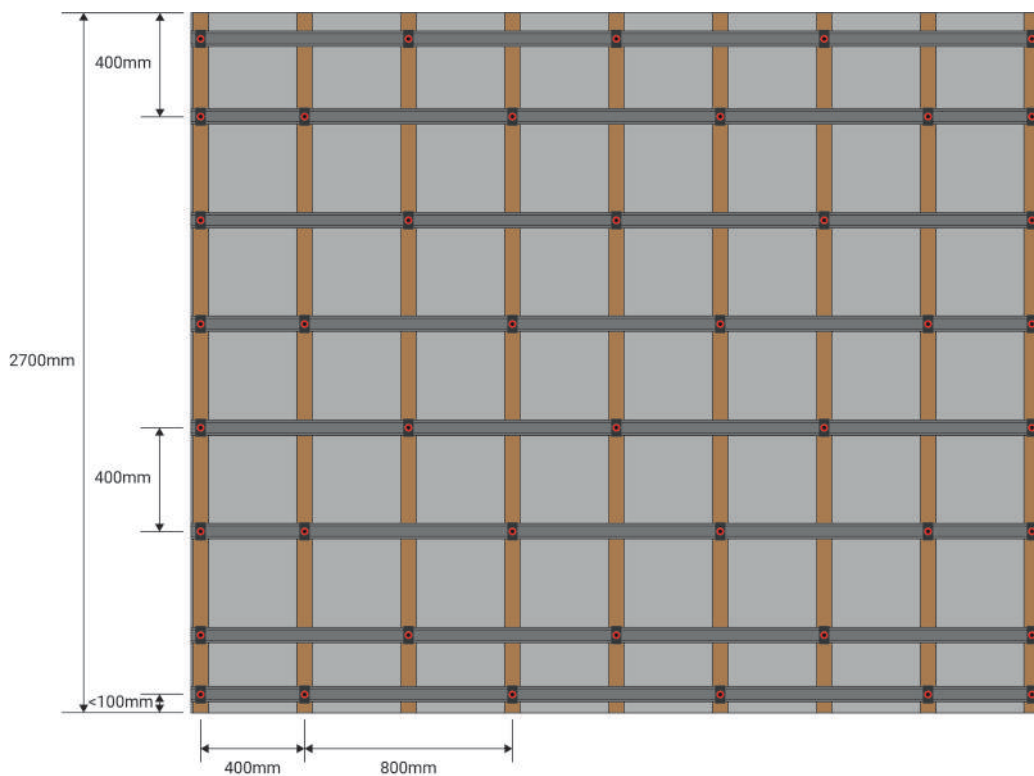

## 4/6 Square

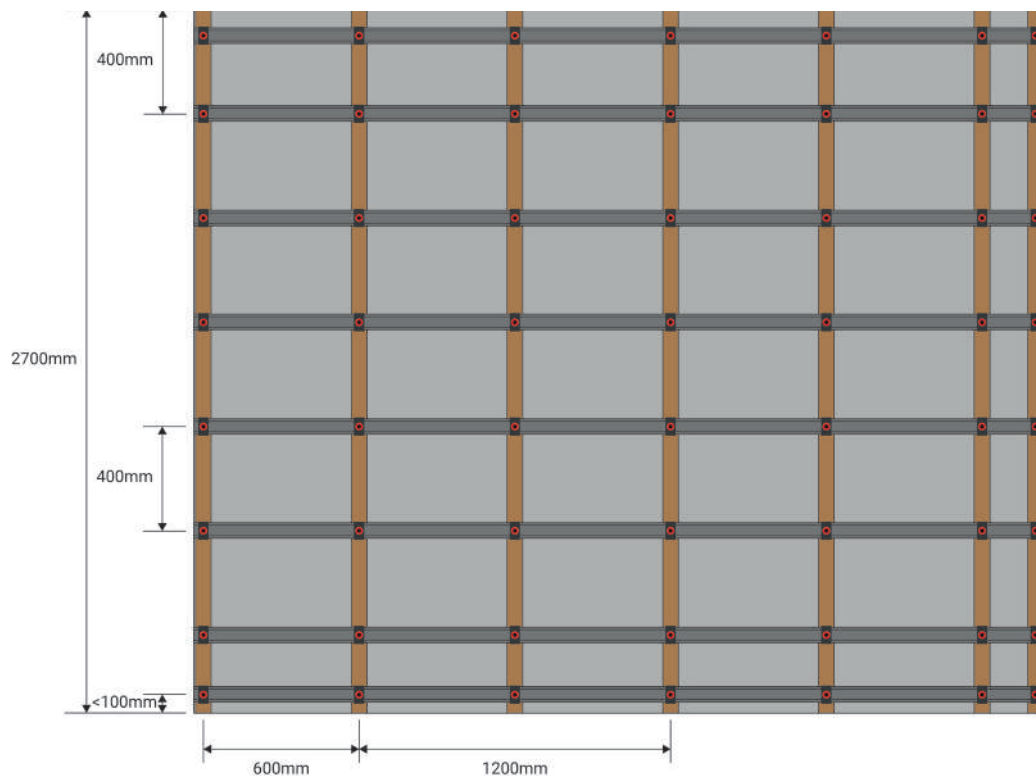

*Please contact iKoustic to confirm correct configurations appropriate for your system.*

**If you need any assistance, please call us on 01937 588 226.**

# MuteClip® XP Installation Guide Ceiling

## To Wooden Joist Ceiling

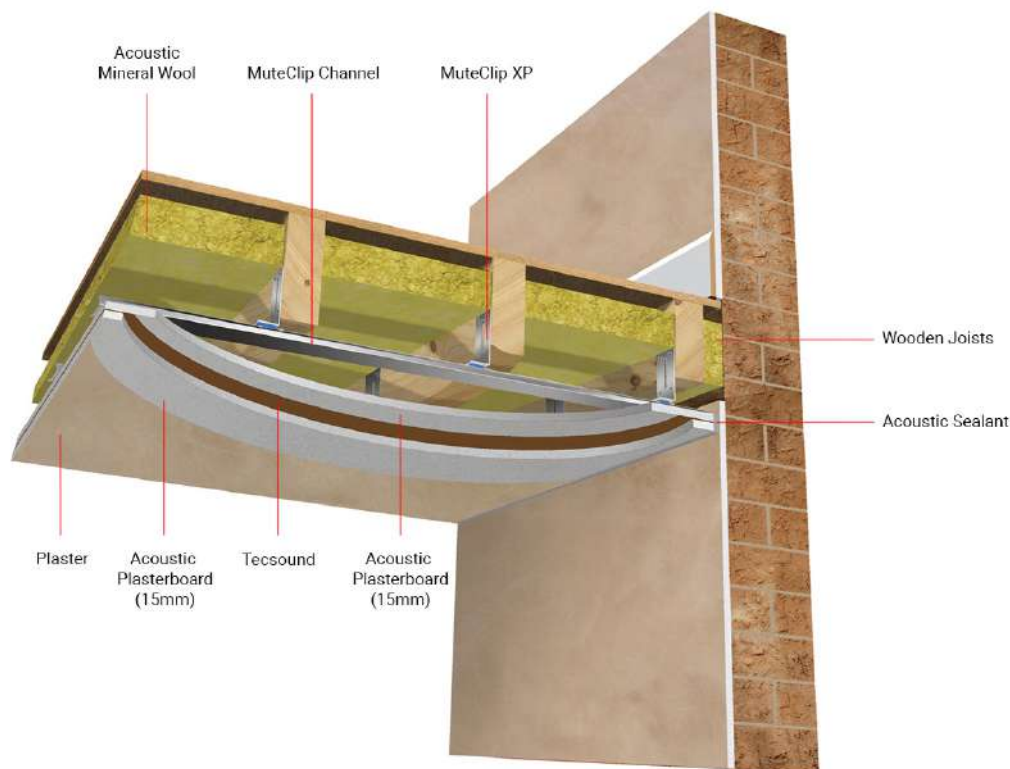

### Fixings

MuteClip XP to Wooden Joist	- 5mm x 50mm Wood Screw
1st Plasterboard to Channel	- 32mm Fine Thread Dry Wall Screw
2nd Plasterboard to Channel	- 50mm Fine Thread Dry Wall Screw
MuteClip Channel Overlap	- 20mm Steel Self-Tapping Screw

*Suitability of fixings to be confirmed by installer.*

### Instructions

- Insert Mineral Wool between the joists
  - + Acoustic Mineral Wool can be friction-held between the joists/ battens, if required use thin wiring to keep it suspended.
- Mark out the locations for the MuteClip XP's (See configurations or contact iKoustic for appropriate dimensions).
  - + The perimeter MuteClip XP's must be no further than 100mm from the adjacent walls.
- Screw MuteClip XP's into all the appropriate joists.
  - + MuteClip XP's central track fixing should be no closer than 25mm from the bottom of the joist.

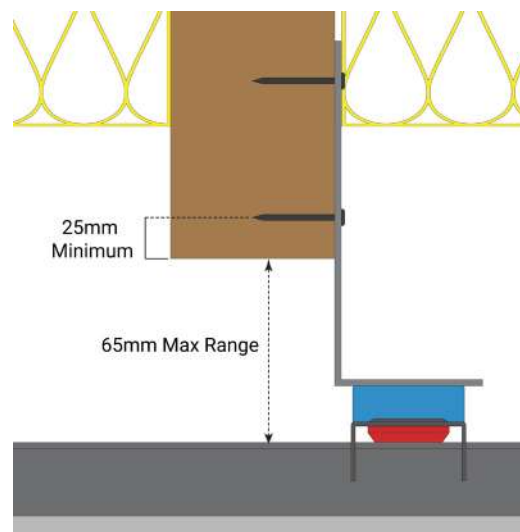



- If using MuteClip XP to level uneven joists, take some time to measure the placement of the MuteClip XP's and Channels.
  - + A laser level should be used when calculating the placement of MuteClip XP.
- Attach MuteClip Channels into MuteClip XP's, channels must run perpendicular to the joists.
  - + MuteClip Channels must overlap by 200mm, fix 4 self-tapping screws into the shoulders of the MuteClip Channels to give a secure join.
  - + MuteClip Channels must not overlap on a MuteClip XP.
- Fix your first layer of Acoustic Plasterboard to the MuteClip Channels.
  - + Acoustic Plasterboard must not be in direct contact with any adjacent surfaces. There must be a 2-5mm gap around the perimeter of the room.
- Seal the perimeter and any other gaps with Acoustic Sealant.
- Adhere Tecsound to the Acoustic Plasterboard using Tecsound's self-adhesive backing.
  - + It may be easier to cut Tecsound into manageable sized pieces for ease of installation.
- Fix your second layer of Acoustic Plasterboard and stagger the joins from the first layer, making sure that the screws go into the MuteClip Channels.
  - + Again, leave a 2-5mm gap around the perimeter of the room.
- Seal the perimeter and any other gaps with Acoustic Sealant.
- Scrim tape all joins and finish with a skim plaster.

## Configurations Standard Diamond XP

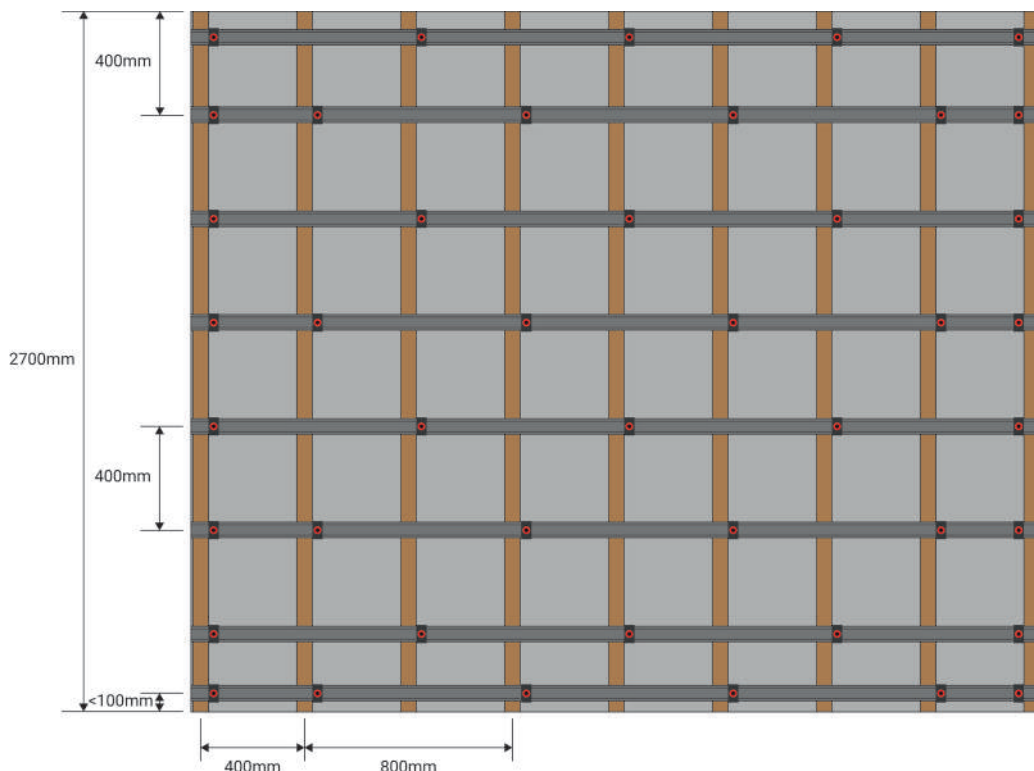

*Please contact iKoustic to confirm correct configurations appropriate for your system.*

**If you need any assistance, please call us on 01937 588 226.**

# MuteClip® LP Installation Guide Ceiling

## To Wooden Joist Ceiling

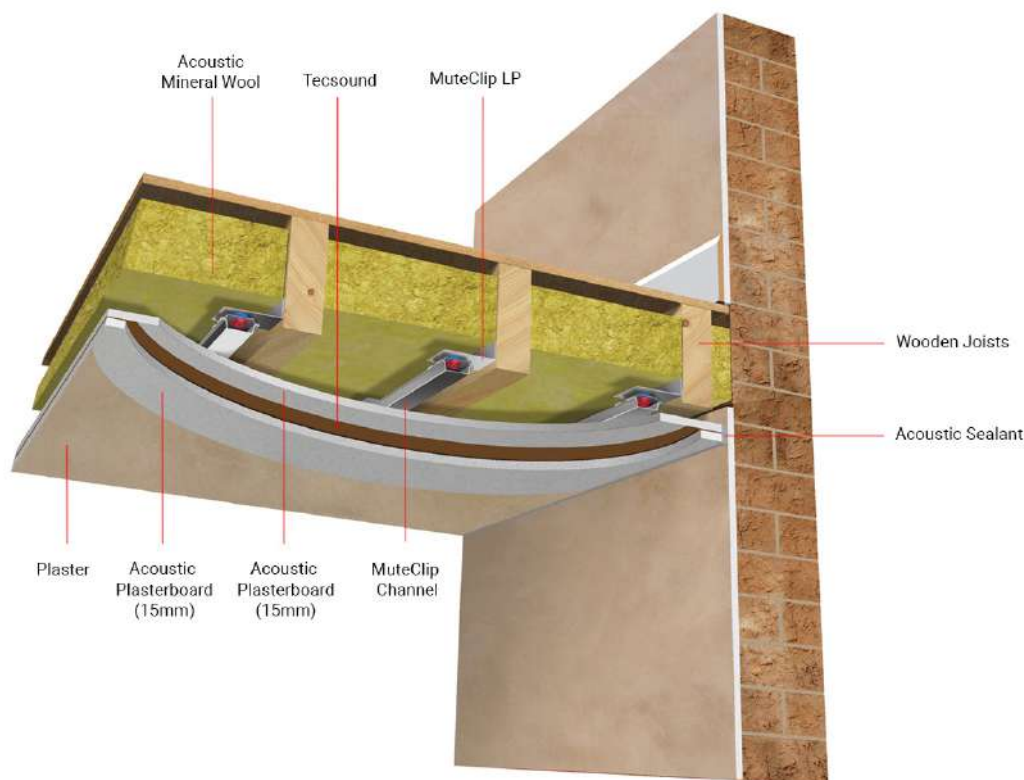

### Fixings

MuteClip LP to Wooden Joist	- 5mm x 50mm Wood Screw
1st Plasterboard to Channel	- 32mm Fine Thread Dry Wall Screw
2nd Plasterboard to Channel	- 50mm Fine Thread Dry Wall Screw
MuteClip Channel Overlap	- 20mm Steel Self-Tapping Screw

*Suitability of fixings to be confirmed by installer.*

### Instructions

- Insert Acoustic Mineral Wool between the joists.
  - + Acoustic Mineral Wool can be friction-held between the joists/battens, if required use thin wiring to keep it suspended.
- Mark out the locations on the side of the joists for the MuteClip LP's (See configurations or contact iKoustic for appropriate dimensions).
  - + MuteClip LP's attach to the side of the joists.
  - + The perimeter MuteClip LP's must be no further than 100mm from the adjacent walls.
- Screw MuteClip LP's into the side of all the appropriate joists.
  - + MuteClip LP's should be no closer than 25mm from the bottom of the joist.

- Take a lot of time to measure when fixing the first MuteClip LP's and MuteClip Channel, as you only want a few mm of the MuteClip Channel sitting proud of the bottom of the joists.
- Attach MuteClip Channels into MuteClip LP's, channels must run parallel to the joists.
  - + MuteClip Channels must overlap by 200mm, fix 4 self-tapping screws into the shoulders of the MuteClip Channels to give a secure join.
  - + MuteClip Channels must not overlap on a MuteClip LP.
- You may wish you install one MuteClip Channel with a couple of MuteClip LP's, then use a laser level to mark along the joist for the rest of the MuteClip LP's
- Fix your first layer of Acoustic Plasterboard to the MuteClip Channels.
  - + Acoustic Plasterboard must not be in direct contact with any adjacent surfaces. There must be a 2-5mm gap around the perimeter of the room.
- Seal the perimeter and any other gaps with Acoustic Sealant.
- Adhere Tecsound to the Acoustic Plasterboard using Tecsound's self-adhesive backing.
  - + It may be easier to cut Tecsound into manageable sized pieces for ease of installation.
- Fix your second layer of Acoustic Plasterboard and stagger the joins from the first layer, making sure that the screws go into the MuteClip Channels.
  - + Again, leave a 2-5mm gap around the perimeter of the room.
- Seal the perimeter and any other gaps with Acoustic Sealant.
- Scrim tape all joins and finish with a skim plaster.

## Configurations

### Standard Diamond LP

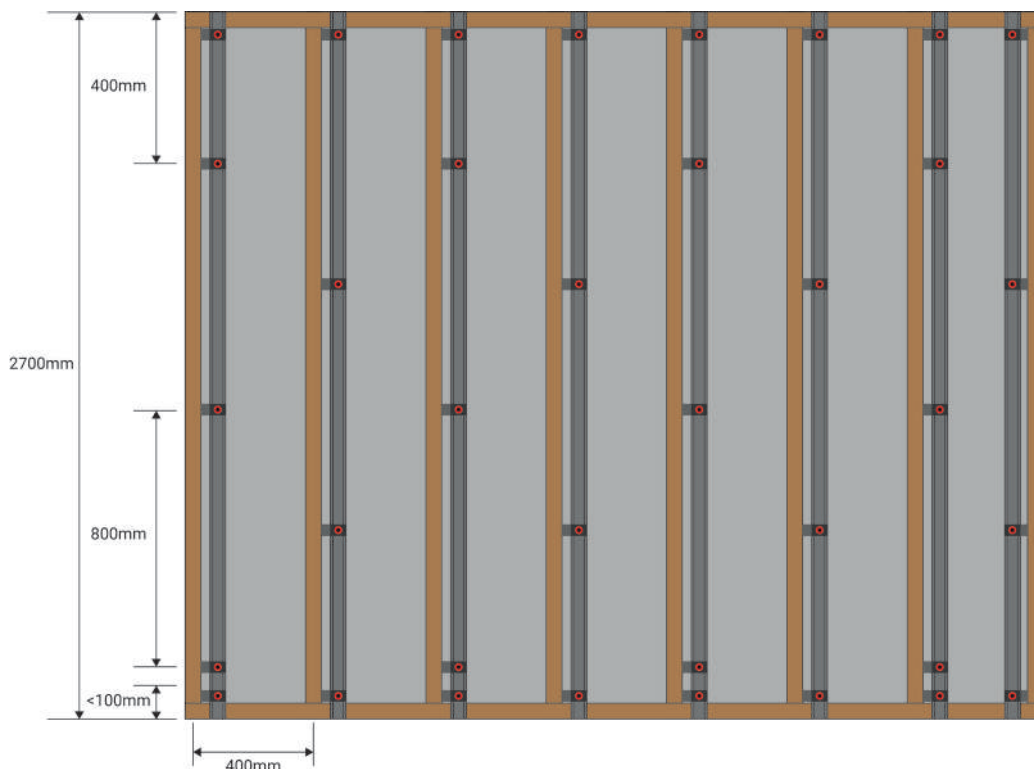

Please contact iKoustic to confirm correct configurations appropriate for your system.

**If you need any assistance, please call us on 01937 588 226.**