



**Versafloor<sup>®</sup>**

---

Product Data  
Loading Data

# Versafloor® Product Data

**Description:** Versafloor® is a tongue and grooved cement particle board which comes in multiple thickness's and provides a high performing acoustic alternative to standard floorboards because of it's additional mass per m2. Because of these properties, it provides significant airborne attenuation in timber structures, as well as floating floor structures including our MuteCradle options.

**Dimensions:** 18mm x 1200mm x 600mm  
22mm x 1200mm x 600mm  
28mm x 1200mm x 600mm

**Mass:** 18mm - 23.4 kg/m<sup>2</sup>  
22mm - 28.6 kg/m<sup>2</sup>  
28mm - 36.4 kg/m<sup>2</sup>

**Sheet Weight:** 18mm - 16.8 kg  
22mm - 20.6 kg  
28mm - 26.2 kg

**Sheet Size:** 0.72 m<sup>2</sup>

**Features and Benefits:** Ideal for upgrade of standard floorboards to improve airborne attenuation.  
Can be used to create a floating floor.  
Mould, moisture and fungus resistant.  
Manageable sized sheets.  
Passes Part E Regulations. *(when used in a system)*  
Tonged and Groove to give an air tight seal when bonded at joints.  
Load bearing subject to load requirement.

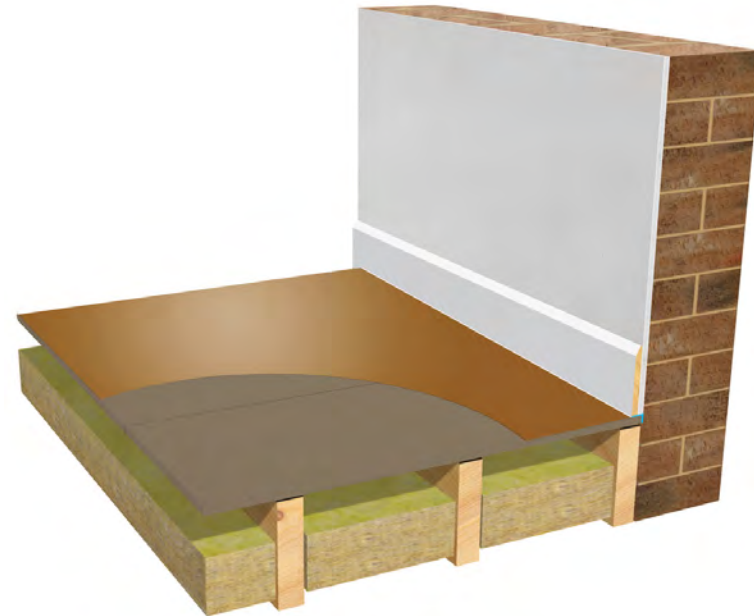

# Versafloor® 18mm Loading Data

Uniformly distributed load (kN/m²)							Concentrated load (kN on 50mm x 50mm square)						
Span (mm)	Single Span			Continuous			Span (mm)	Single Span			Continuous		
	Load limited by stress	Load limited by deflection		Load limited by stress	Load limited by deflection			Load limited by stress	Load limited by deflection		Load limited by stress	Load limited by deflection	
		Span/300	Span/500		Span/300	Span/500			Span/300	Span/500		Span/300	Span/500
300	10.6	-	-	13.3	-	-	300	0.4	-	-	0.7	-	-
400	5.9	-	5.2	7.4	-	-	400	0.4	-	-	0.6	-	-
500	3.7	-	2.7	4.6	-	-	500	0.4	-	-	0.6	-	-
600	2.5	-	1.6	3.2	-	2.9	600	0.3	-	-	0.5	-	-
700	1.8	1.6	1.0	2.3	-	1.9	700	0.3	-	-	0.5	-	-
800	1.3	1.1	0.7	1.7	-	1.2	800	0.3	-	-	0.5	-	-
900	1.0	0.8	0.5	1.3	-	0.9	900	0.3	-	-	0.5	-	-
1000	0.8	0.6	0.3	1.0	-	0.6	1000	0.3	-	-	0.5	-	-

\* Please seek the advice of a loading engineer if unsure.

# Versafloor® 22mm Loading Data

Uniformly distributed load (kN/m²)							Concentrated load (kN on 50mm x 50mm square)						
Span (mm)	Single Span			Continuous			Span (mm)	Single Span			Continuous		
	Load limited by stress	Load limited by deflection		Load limited by stress	Load limited by deflection			Load limited by stress	Load limited by deflection		Load limited by stress	Load limited by deflection	
		Span/300	Span/500		Span/300	Span/500			Span/300	Span/500		Span/300	Span/500
300	15.9	-	-	19.9	-	-	300	0.6	-	-	1.0	-	-
400	8.8	-	-	11.1	-	-	400	0.6	-	-	0.9	-	-
500	5.5	-	4.9	7.0	-	-	500	0.5	-	-	0.8	-	-
600	3.8	-	2.8	4.8	-	-	600	0.5	-	-	0.8	-	-
700	2.7	-	1.8	3.4	-	3.4	700	0.5	-	-	0.8	-	-
800	2.0	2.0	1.2	2.6	-	2.3	800	0.5	-	-	0.7	-	-
900	1.5	1.4	0.8	2.0	-	1.6	900	0.4	-	-	0.7	-	-
1000	1.2	1.0	0.6	1.5	-	1.2	1000	0.4	-	-	0.7	-	-

\* Please seek the advice of a loading engineer if unsure.

# Versafloor® 28mm Loading Data

Uniformly distributed load (kN/m²)							Concentrated load (kN on 50mm x 50mm square)						
Span (mm)	Single Span			Continuous			Span (mm)	Single Span			Continuous		
	Load limited by stress	Load limited by deflection		Load limited by stress	Load limited by deflection			Load limited by stress	Load limited by deflection		Load limited by stress	Load limited by deflection	
		Span/300	Span/500		Span/300	Span/500			Span/300	Span/500		Span/300	Span/500
300	25.8	-	-	32.3	-	-	300	1.0	-	-	1.6	-	-
400	14.4	-	-	18.0	-	-	400	0.9	-	-	1.5	-	-
500	9.1	-	-	11.4	-	-	500	0.9	-	-	1.4	-	-
600	6.2	-	5.9	7.8	-	-	600	0.8	-	-	1.3	-	-
700	4.5	-	3.7	5.7	-	-	700	0.8	-	-	1.2	-	-
800	3.3	-	2.5	4.3	-	-	800	0.8	-	-	1.2	-	-
900	2.6	-	1.7	3.3	-	3.3	900	0.7	-	-	1.2	-	-
1000	2.0	-	1.3	2.6	-	2.4	1000	0.7	-	-	1.1	-	-

\* Please seek the advice of a loading engineer if unsure.